

Electrical Legend

- 13Amp fused switched spur with neon light at high level and unswitched socket at low level
- Light Switch (2 - 2 way)
- 13Amp Double Socket Outlet
- Intercom System
- Smoke Detector
- Smoke Detector (LD2)
- Heat Detector
- Heat Detector (LD2)
- Carbon Monoxide Detector
- 13Amp Fused Switched Spur with neon light
- Consume Unit (1350-1450mm above FFL)
- Pendant Light
- Batten Light
- Wall Light
- Cooker Control Spur with outlet below bench
- 13Amp Double Socket Outlet at high level
- Ceiling Mounted Extract Fan
- EF Wall Mounted Extract Fan
- Thermostat
- External wall mounted light

Fibre Optic Legend

- Fibre Optic Installation (Installation as per Fibre Optic requirement notes and setting out)
- Fibre Broadband Inlet. (Outlet box back to back where adjacent hub, or microduct to hub if located remotely)

Fibre Installation

Installation to be as per latest 'FibreNest // Advice Note for Electricians'

NOTE:
External Doors sizes to manufactures details. Lintels to suit door sizes.

For Construction
Details refer to Group
Specification

Means of Escape
All fire doors (flat entrance doors to service cupboards in common areas) must be fitted with:

- (a) Intumescent strips on side and top edges.
 - (b) Smoke seals on side and top edges.
 - (c) High melting point metal hinges.
 - (d) A positive self-closing device (Except those which are normally kept closed and locked shut)
- The self closing device should close the door in a controlled manner from any angle and be strong enough to overcome the resistance of any latch and comply with BS EN 1154.

All doors forming part of the means of escape must be maintained readily available, without the use of keys at all times. Each door should only be secured by a single fastening device.

Fire Alarm System

It is expected that a stand alone fire alarm system will be provided within each flat, designed and installed to BS5839-6:2019 using interlinked Grade D1 detectors (where property may be let).

As the building is under 4.5m to the first floor, providing that escape windows are provided in each flat, there would be no requirement for an AOV or smoke detection in the common areas.

Emergency Lighting System

The common areas only of the premises should be provided with a secondary lighting system conforming to the recommendations of British Standard 5266 - 1:2016. The system should:

- (a) Illuminate all internal (and external) means of escape routes including stairways, corridors and circulation areas.
- (b) Operate on failure of the lighting circuit(s), i.e., not just total mains failure.

Signs and Notices

Signs and notices should be provided in accordance with the guidance contained in BS5499-10:2014 and BS 5499-4:2013 in common areas of the building only.

Fire Tender

Suffolk Fire and Rescue Service also requires a minimum carrying capacity for hard standing for pumping appliances of 15 tonnes.

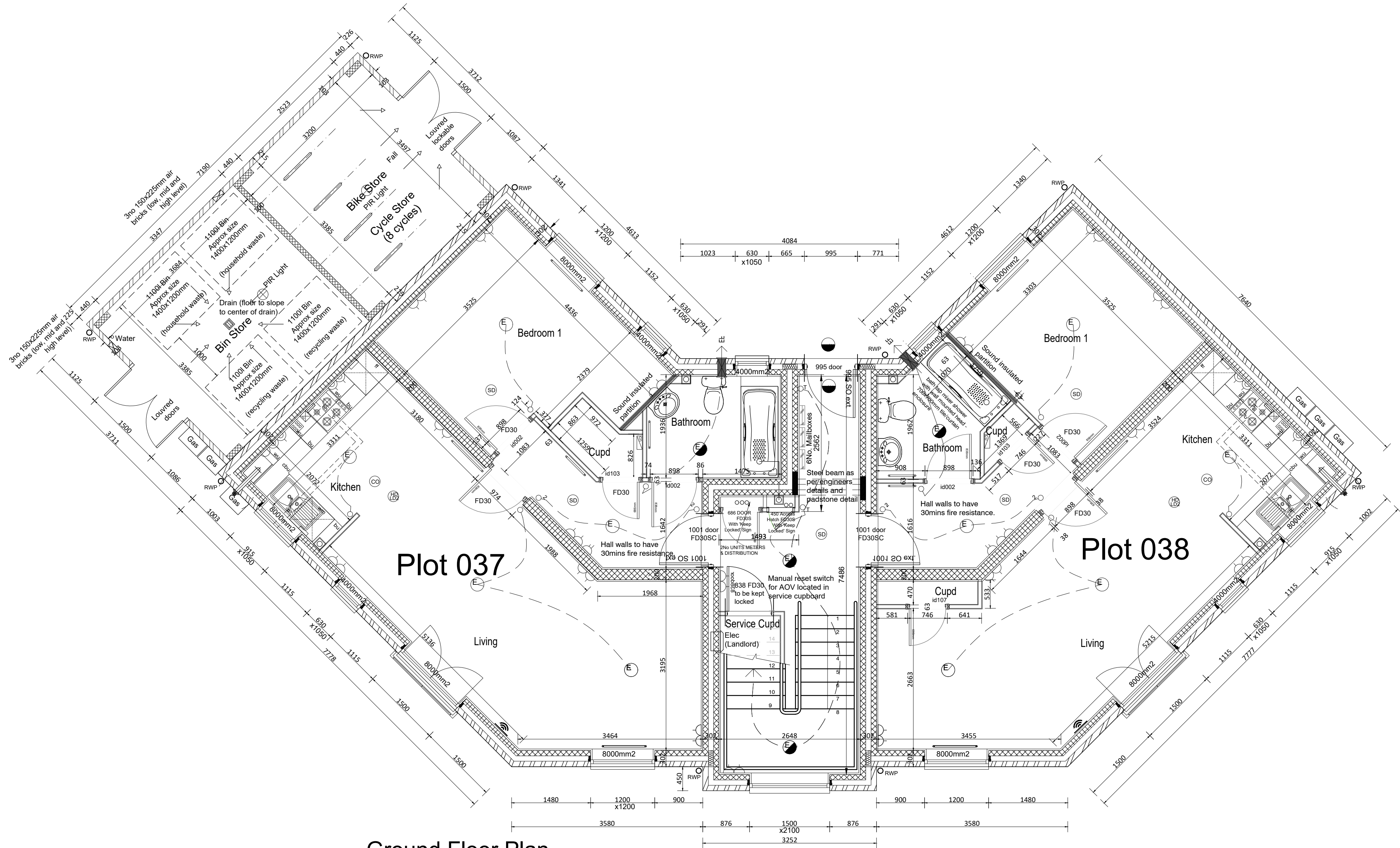

Ground Floor Plan

Note & Key

F	Service riser cupboard doors amended size	SN	24.04.23
E	2013 Regs added to title block	AHi	09.03.23
D	Extra dimensions added and bin/cycle store fall arrows shown	SN	14.02.23
C	RWP's added to bin/cycle store added, drain relocated to center of bin store and two extra mail boxes added (6 total)	SN	12.05.22
B	Dimensions amended, front door size, fibre nest and smoke detectors added	SN	22.12.21
A	BD1 partition wall moved and Cupboard added to living room.	SN	15.04.21
Rev	Description	By	Date



Persimmon Homes Ltd.
Persimmon House
Orion Court
Great Blakenham
Suffolk IP6 0LW
Tel 01473

Site Name:

**Hadleigh
Phase 2
Charles Church**

Drawing:

**Piel CA5
Ground Floor Plan**

AP-37, 38, 39, 40, 41, 42
H-

2013 Regs

Scale@A1:

1:50

Date:

Aug'20

Drawn By:

CT

Checked By:

JE

Drawing No:

941-T-13-038.2

Rev:

F